



Qualys Connector v1.7.0

Release Notes

Version 1.7.0

June 06, 2023

What's new?

Common Feature

Configure FlexScan on Connector List Screen

We have introduced an option to configure FlexScan for your connectors in the Connector list screen. You can no longer configure FlexScan for new and existing connectors from the **Create/Edit connector** wizard. Instead, select the required account-level connector for FlexScan configuration from the Connectors application and click **Configure FlexScan**.

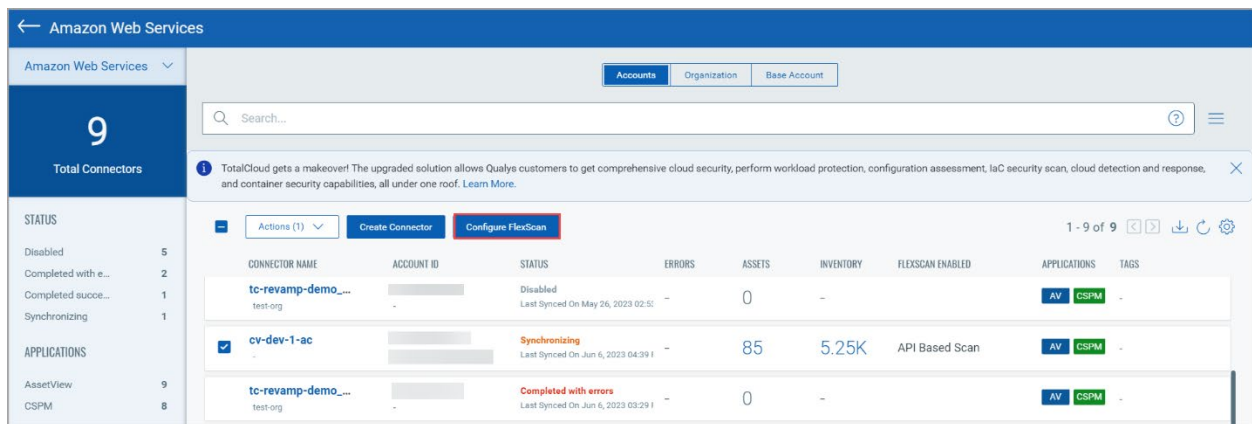

You can select from available FlexScan methods such as API-based scan, Snapshot-based scan, or Cloud Perimeter Scan.

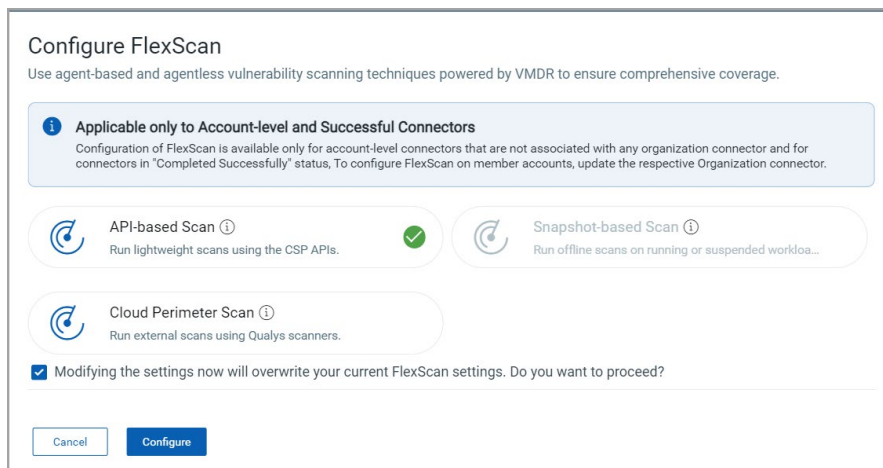

When selecting connectors for FlexScan configuration, do not choose member account connectors of an organization or connectors of incomplete status. These connectors are not eligible for FlexScan configuration.